

# fischer

## Montagemörtel FIS VL 150 C

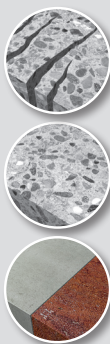

# fischer Montagemörtel FIS VL



**DE** Gebrauchsanweisung

**EN** Operating instructions

**FR** Mode d'emploi

**NL** Montagehandleiding

**IT** Istruzioni per l'installazione

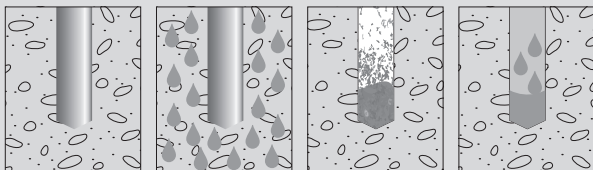

<b>DE</b>	Trockener Beton	Nasser Beton	Verschmutztes Bohrloch	Wassergefülltes Bohrloch
<b>EN</b>	Dry concrete	Wet concrete	Contaminated drill hole	Waterfilled drill hole
<b>FR</b>	Béton sec	Béton humide	Perçage non dépolssiéré	Trou inondé
<b>NL</b>	Droog beton	Met water verzaadigd beton	Vervuild boorgat	Met water gevuld boorgat
<b>IT</b>	Calcestruzzo secco	Calcestruzzo saturo d'acqua	Foro sporco	Foro pieno d'acqua nel calcestruzzo

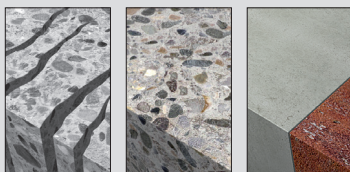

<b>DE</b>	Gerissener Beton	Ungerissener Beton	Vollstein
<b>EN</b>	Cracked concrete	Non-cracked concrete	Solid brick
<b>FR</b>	Béton fissuré	Béton non fissuré	Maçonneries pleines
<b>NL</b>	Gescheurd beton	Ongescheurd beton	Volle steen
<b>IT</b>	Calcestruzzo fessurato	Calcestruzzo non fessurato	Mattone pieno

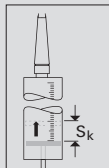
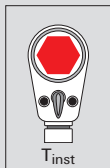

**DE** Drehmoment

Verarbeitungszeit

Aushärtezeit

Skalenteile

**EN** Required torque

Open time

Hardening time

Scale divisions

**FR** Couple

Temps de  
manipulation

Temps de  
durcissement

Graduations

**NL** Draaimoment

Verwerkingstijd

Uithardtijd

Schaalonderdelen

**IT** Coppia

Tempo di  
lavorazione

Tempo di  
indurimento

Divisioni di scala



STOP

01/21

OK?

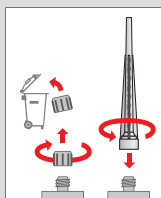
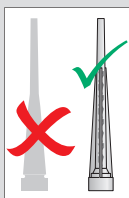
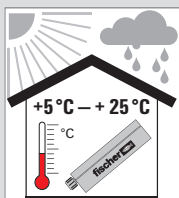

FIS MR Plus

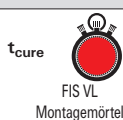
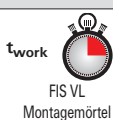
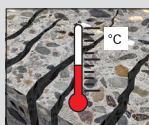

Temperature Range (°C)	t <sub>work</sub> (min)	t <sub>cure</sub> (h)
> -10 °C - -5 °C	-	-
> -5 °C - ±0 °C	-	24 h
> ±0 °C - +5 °C	13 min.	3 h
> +5 °C - +10 °C	9 min.	90 min.
> +10 °C - +20 °C	5 min.	60 min.
> +20 °C - +30 °C	4 min.	45 min.
> +30 °C - +40 °C	2 min.	35 min.

		Art. No.	
150 ml	KPM 2	053117	FIS MR Plus



FIS A

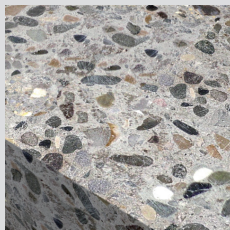

## FIS A

	<b>M12</b>
	✓
	✓
	$d_o$ [mm] 14
	$h_{o,min}$ [mm] 70 $h_{o,max}$ [mm] 240
	fischer BS $\varnothing$ 14 $d_b$ [mm] 16
	$d_f$ [mm] 14
	$d_f$ [mm] 16
	$Sk(h_{o,min})$ [-] 3 $Sk(h_{o,max})$ [-] 10
	$T_{inst,max}$ 40



FIS A



## FIS A

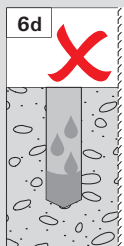
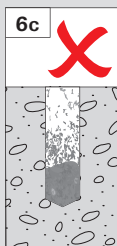
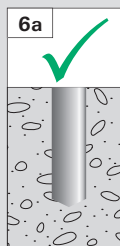
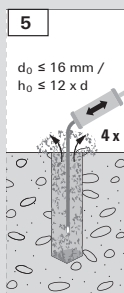
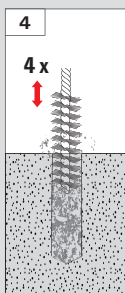
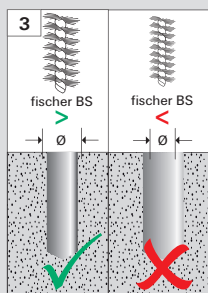
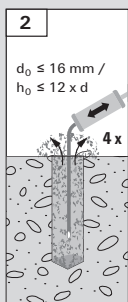
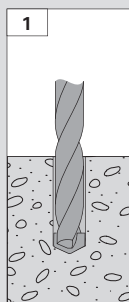



FIS A



## FIS A

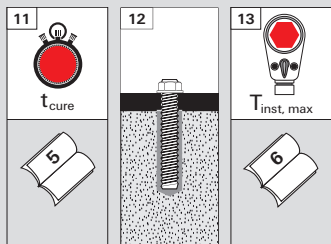
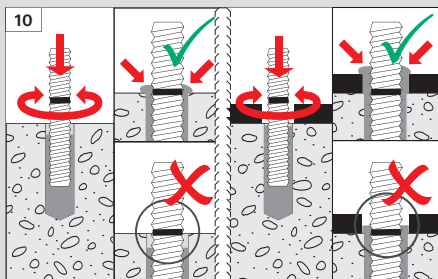
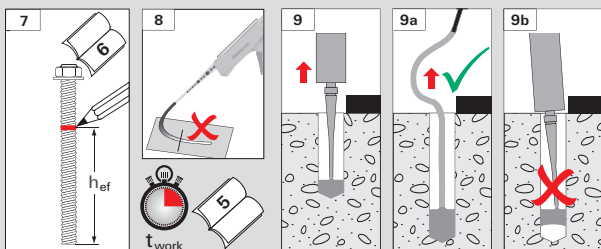





FIS A



## FIS A

	FIS A	<b>M12</b>
		✓
	$d_0$ [mm]	14
	$h_{0,min}$ [mm]	50
	$h_{0,max}$ [mm]	100
	fischer BS	Ø 14
	$d_b$ [mm]	16
	$d_f$ [mm]	14
	$d_f$ [mm]	16
	$Sk(h_{0,min})$ [-]	3
	$Sk(h_{0,max})$ [-]	5
	$T_{inst,min}$ [Nm]	0
	$T_{inst,max}$ [Nm]	10



FIS A



## FIS A

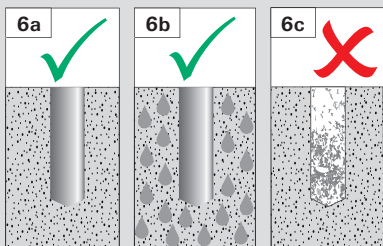
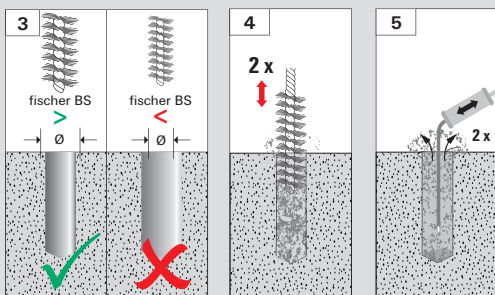
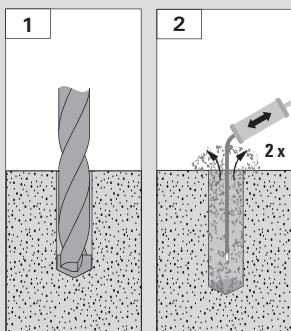



FIS A



## FIS A

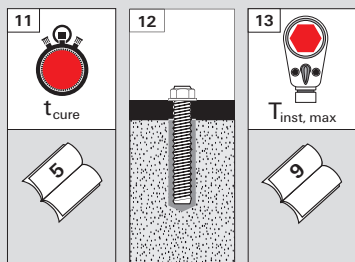
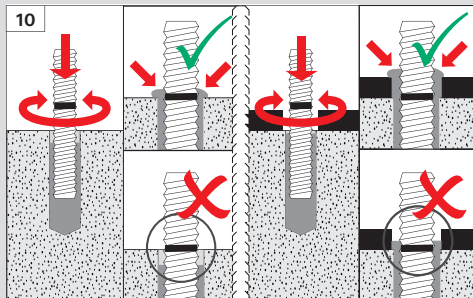
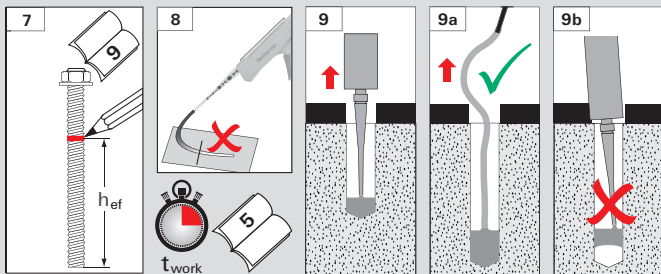

## Contact

**fischerwerke  
GmbH & Co. KG**  
Klaus-Fischer-Straße 1  
72178 Waldachtal  
Germany  
Phone +49 7443 12-0  
[www.fischer.de](http://www.fischer.de)  
[info@fischer.de](mailto:info@fischer.de)



[www.fischer.de](http://www.fischer.de)



-  **fischer Deutschland  
Vertriebs GmbH**  
Klaus-Fischer-Straße 1  
72178 Waldachtal  
Tel. +49 744312-6000
-  **fischer Austria GmbH**  
Wiener Straße 95  
2514 Traiskirchen  
Tel. +43 2252 53730-0
-  **fischer fixings (UK) Ltd**  
Whitely Road  
Wallingford, Oxfordshire  
OX10 9AT  
Tel. +44 1491 827900
-  **fischer S.A.S.**  
12, Rue Livio, B.P. 10182  
67022 Strasbourg-Cedex 1  
Tel. +33 388 391867
-  **fischer Cobemabel snc**  
Schaliënhoeverdreef 20D  
2800 Mechelen  
Tel. +32 15 28 47 00
-  **fischer Benelux B.V.**  
Amsterdamsestraatweg 45 B/C  
1411 AX Naarden  
Tel. +31 35 6956666
-  **fischer italia s.r.l.**  
Corso Stati Uniti, 25  
Casella Postale 391  
35127 Padova - Z.I. Sud  
Tel. +39 049 8063-111
-  **fischer Ibérica S.A.**  
C/ Klaus Fischer, 1  
43300 Mont-roig del Camp  
Tarragona  
Tel. +34 977 8387-11
-  **fischerwerke Portugal, Lda**  
Rua das Musas, Passeio dos  
Cruzados Lote 2.01 (Bloco3),  
Loja 8 (01.D) / Parque das Nacoes  
1990-171 Lisboa  
Tel. +351 21 8 954 180
-  **fischer a/s**  
Sandvadsvej 17 A, 4600 Køge  
Tel. +45 463 20220
-  **fischer Sverige AB**  
Tennkatan 4, 602 23 Norrköping  
Tel. +46 11 31 44 50
-  **fischer Norge AS**  
Oluf Onsumsvei 9, 0680 Oslo  
Tel. +47 23 24 27-10

-  **fischer Finland**  
Suomalarstentie 7B  
02270 Espoo  
Puh. +358 20 7414660
-  **fischerpolska sp. z o. o.**  
ul. Albatrosów 2  
30-716 Kraków  
Tel. +48 12 290 08 80
-  **fischer international  
s.r.o.**  
Průmyslová 1833  
250 01 Brandýs nad Labem  
Tel. +420 326 904 601
-  **fischer SK s.r.o.**  
Nová Rožnavská 134 A  
831 04 Bratislava  
Tel. +421 2 4920 6046
-  **fischer Hungária Bt.**  
Szerémi út 7/b  
1117 Budapest  
Tel. +36 1 34797-55
-  **fischer Hrvatska d.o.o.**  
Nadinska 29  
10010 Zagreb
-  **fischer Metal San.  
ve Tic. Ltd Sti**  
Cevizli Mahallesi Mustafa Kemal  
Cad. No. 66,  
Hukukular Towers A Blok Kat 9  
34865 Kartal Istanbul I  
Tel. +90 216 326 0066
-  **fischer Hellas  
Emporiki EPE**  
National Road  
Athens-Lamia (17th)  
& Roupel 6  
145 64 Kifissia, Athens  
Tel. +30 210 2838167
-  **ООО Фишер Крепежные  
Системы Рус**  
129226, г. Москва, Россия  
Ленинградское шоссе 47, стр.2  
Тел./факс: +7-495-22361
-  **fischer (Taicang)  
fixings Co., Ltd.**  
Shanghai Rep. Office  
Rm 1503-1504, Design Building  
No. 63 Chifeng Road  
200092 Shanghai  
Tel. +86 21 51 00 16 68

-  **fischer Japan K.K.**  
Seishin Kudan Building  
3rd Floor  
3-4315 Kudan Minami  
Chiyoda-ku  
Tokyo 102-0074  
Tel. +81 3 3263 4491
-  **fischer systems Asia  
Pte Ltd**  
4 Kaki Bukit Ave.  
#01-06  
417939 Singapore  
Tel. +65 62 85 22 07
-  **fischer Korea Co. Ltd.**  
B-903, #131,  
Kasan Digital-1Ro,  
Geumcheon-Gu  
153-803 Seoul  
Tel. +82 1544 8955
-  **fischer FZE**  
P.O. Box 261738  
Jebel Ali Free Zone  
Dubai  
Tel. +97 1 48 83 74 77
-  **fischer fixings LLC**  
205 US HWY 46, Suite 4  
07512 Totowa, New Jersey  
Tel. +1 973 256 3045
-  **fischer Argentina S.A.**  
Armenia 3044, 1605 Munro  
Buenos Aires  
Tel. +54 11 4721 7700
-  **fischer Brasil Indústria  
e Comércio Ltda.**  
Avenida Marginal Projetada  
1652 Galpao  
15 - Barueri / Sao Paulo  
Tel. +55 11 3178-2545
-  **fischer Sistemas  
de Fijación, S.A. de C.V.**  
Bvd. Manuel Avila Camacho  
No. 3130 Oficina 400B  
Col. Valle Dorado  
C.P. 54020 Tlalneapantla  
RFC: FSFO606140C2  
Tel. +52 55 5572-0883